

6

5

4

3

2

1

F

E

D

C

B

A

F

E

D

C

B

A

DESCRIPTION	MATERIAL	FINISH
CENTER CONTACTS	BRASS	GOLD
BODY-1	BRASS	NICKEL
BODY-2	BRASS	NICKEL
SHELL	BRASS	NICKEL
CRIMP FERRULE	BRASS	NICKEL
INSULATOR	DELRIN	-

REVISION					
ZONE	REV	DESCRIPTION	DATE	CHANGED BY	APPROVED
	C	ECO-15259	12/12/2025	DMAY	SRAUTUS

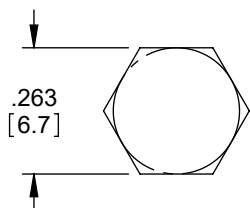
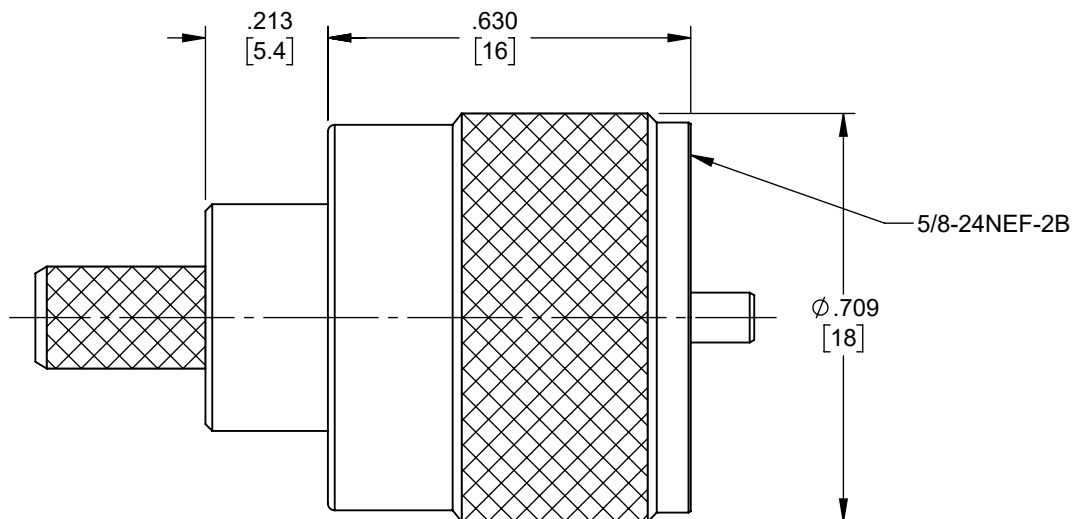
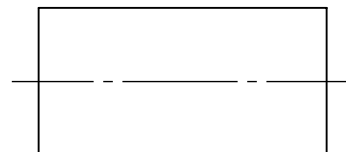

RECOMMENDED
FERRULE
CRIMP SIZE

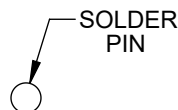

RECOMMENDED
-SOLDER PIN-

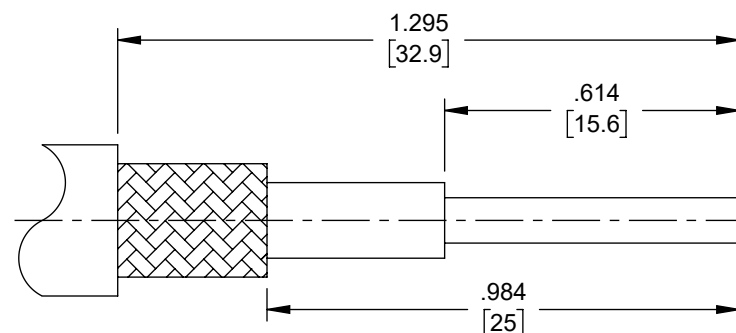

RECOMMENDED CABLE
STRIPPING

NOTES:

1. ELECTRICAL:

- IMPEDENCE: 50 OHMS
- WITHSTAND VOLTAGE: 1000V
- FREQUENCY RANGE: 0~300 GHz
- VSWR: <1.50 @ 0~6 GHz
- DURABILITY: > 500 CYCLE
- CABLE RETENTION: > 40 POUNDS

2. MISCELLANEOUS:

COMPONENTS SHALL BE INDIVIDUALLY PACKAGED

REGULATORY COMPLIANCE:

EU RoHS DIRECTIVE (MOST RECENT RELEASED VERSION)

THE INFORMATION CONTAINED IN THIS DRAWING IS THE SOLE PROPERTY OF INFINITE ELECTRONICS, INC. ANY REPRODUCTION IN PART OR WHOLE WITHOUT THE WRITTEN PERMISSION OF INFINITE ELECTRONICS, INC. IS PROHIBITED. THESE COMMODITIES, TECHNOLOGY OR SOFTWARE WERE EXPORTED FROM THE UNITED STATES IN ACCORDANCE WITH THE EXPORT ADMINISTRATION REGULATIONS. DIVERSION CONTRARY TO U.S. LAW PROHIBITED.

UNLESS OTHERWISE SPECIFIED LEADING DIMENSIONS ARE INCHES DIMENSIONS IN [] ARE MILLIMETERS		L-com® an INFINIT® brand Website: www.L-com.com Phone: 1.800.341.5266 1.978.682.6936		INTERPRET ALL DIMENSIONS AND TOLERANCES PER ASME Y14.5	
TOLERANCES: X = ±.2 [5] .XX = ±.02 [0.5] .XXX = ±.005 [0.13]		FRACTIONS ± 1/32 ANGLES ± 1°		SCALE NONE	SHEET 1 OF 1
CABLE LENGTH TOLERANCES: ≤12 [305] = +1 [25] / -0 >12 [305] ≤ 60 [1524] = +2 [51] / -0 >60 [1524] ≤ 120 [3048] = +4 [102] / -0 >120 [3048] ≤ 300 [7620] = +6 [152] / -0 >300 [7620] = +5% / -0		DESCRIPTION UHF MALE CRIMP (TYPE PL259) FOR RG58, 195-SERIES CABLE			
SIZE A	CAGE CODE 43321	DRAWN BY BPUCHASKI	ITEM NO. AUM-1700	REV C	