

THE INFORMATION CONTAINED IN THIS DRAWING IS THE SOLE  
PROPERTY OF L-COM, INC. ANY REPRODUCTION IN PART OR WHOLE  
WITHOUT THE WRITTEN PERMISSION OF L-COM, INC. IS PROHIBITED.

REVISIONS			
REV	DESCRIPTION	DATE	APPROVED
A	DRAWING REPLACES SD9S-PC-OD1	6/25/14	D. DESJARDIN

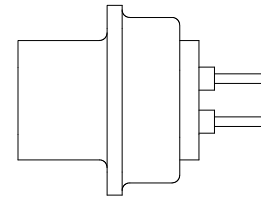
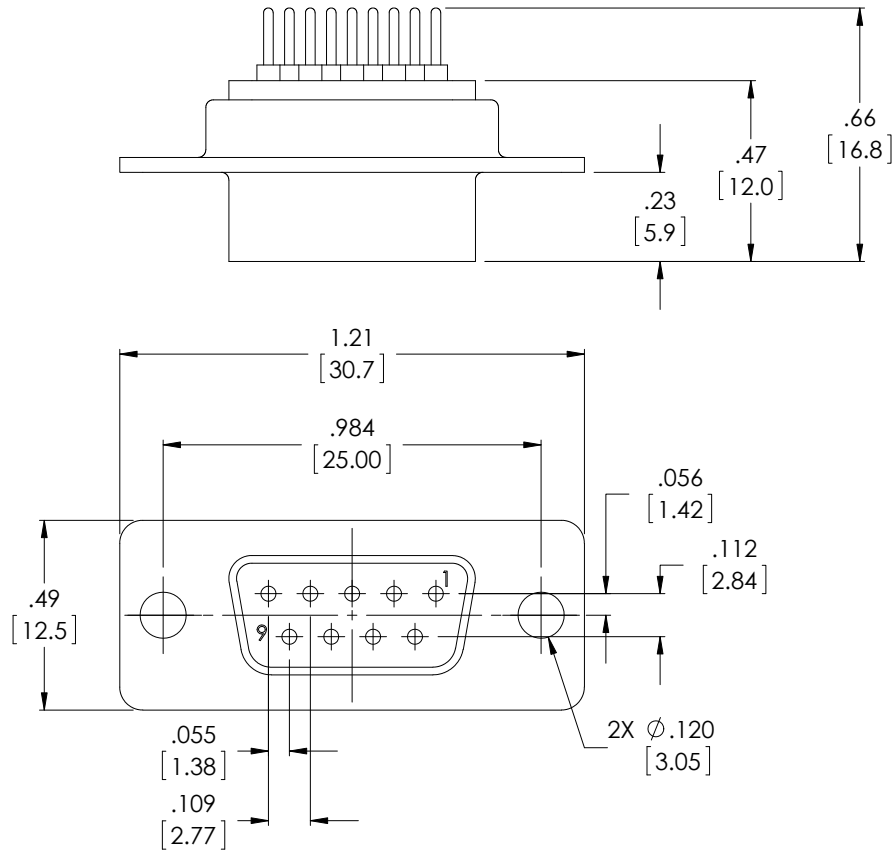

#### NOTES:

##### 1. MATERIAL:

SHELL: COLD ROLLED STEEL  
CONTACTS: BRASS  
INSULATOR: THERMOPLASTIC PBT (UL 94V-0 RATED), BLUE

##### FINISH:

SHELL: TIN PLATED  
MATING CONTACTS: GOLD SELECTIVE PLATED

##### ELECTRICAL:

CURRENT RATING: 5 AMP  
DIELECTRIC WITHSTANDING VOLTAGE: 1000 VAC  
INSULATION RESISTANCE: 1000 MΩ PER MINUTE @500 VDC  
CONTACT RESISTANCE: 20mΩ MAX

##### ENVIRONMENTAL:

OPERATING TEMPERATURE RANGE: -55°C TO +105°C

2. COMPONENT SHALL BE INDIVIDUALLY PACKAGED IN  
ACCORDANCE WITH L-COM SPECIFICATION PS-0031.

##### REGULATORY COMPLIANCE:

CE2011/65/EU(RoHS DIRECTIVE)

UNLESS OTHERWISE SPECIFIED, DIMENSIONS ARE IN INCHES [mm] OVERALL CABLE LENGTH TOLERANCE: ≤12 [305] = +1 [25] / -0 >12 [305] ≤60 [1524] = +2 [51] / -0 >60 [1524] ≤120 [3048] = +4 [102] / -0 >120 [3048] ≤300 [7620] = +6 [152] / -0 >300 [7620] = +5% / -0% ALL OTHER DIMENSIONAL TOLERANCES: .X = ±.2 [5.08] .XX = ±.02 [51] .XXX = ±.005 [13] PROJECTION 	APPROVALS	DATE	 45 BEECHWOOD DRIVE NORTH ANDOVER, MA 01845	
	DRAWN BY B. MAZEJKA	12/18/2003		
	CHECKED BY C. MCCORMICK	12/19/2003	CATEGORY D-SUBMINIATURE	
	APPROVED BY D. PARHAM	12/19/2003	PRODUCT DESCRIPTION CONNECTOR, DB9F PCB	
CONFIGURATION DETAILS OF UNDIMENSIONED FEATURES MAY VARY		SIZE <b>A</b>	FSCM NO. <b>43321</b>	DWG. NO. SD9S-PC
COLOR VARIATIONS MAY OCCUR		SCALE: NONE	CAD FILE: SD9S-PC.SLDDRW	REV. <b>A</b>
SD9S-PC-OD1		SHEET 1 OF 1		